

Architectural Control Committee Meeting

May 6, 2024

Attendees Directors: Phil Ross, Bill Stimmel, Kathy Alexander

Homeowner: Sheri McClelland

The meeting was held at Bill Stimmel's home at 2668 Breton Ridge Dr. It was called to order at 7:05 pm by the President, Phil Ross.

Phil noted that a quorum of 3 directors were in attendance-Phil, Bill and Kathy.

The HOA had received a request for approval for an architectural change to 5711 Sumpter Hill Dr. The homeowner was not present. There was discussion about the proposed construction of an enclosed sunroom addition on the house, roughly in the space of the existing rear porch plus 10'.

There was a motion by Phil Ross, seconded by Kathy Alexander, to approve the project with the requirement that the materials be consistent with the existing porch structure, the architectural shingles in particular.

The motion was unanimously approved by the directors.

The meeting was adjourned at 7:15 pm.

Minutes by Kathy Alexander

Improvements other than New Home Construction

Application for Approval of the
Bull Run Unit 1 Homeowners Association
Architectural Control Committee

Date Submitted 4/10/24

Property Owner Information:

Name: Leqi Cui

Address 5711 Sumter Hill Ln

Phone 701-404-6340 Email leqicui@hotmail.com

Project (please check all that are applicable):

DETACHED STRUCTURE HOUSE ADDITION

FENCE POOL SCREENED PORCH

DECK LANDSCAPING TREE REMOVAL

OTHER (Describe) Sunroom (glass) white in color

Please provide a brief description of the proposed project: Extend existing screen porch w/ new deck to create a 12' x 20' glass sunroom

Proposed Start Date: 5/8/24 Projected Completion Date: 5/15/24

Contractor Information:

Licensee Name: Razzie Strickland

Business Name: NRG Industries

Address: 640 Capital Cir NE Tallahassee FL 32301

Contact Name & Phone Number: Amanda Ross 850-224-7433

License Number: CRC1332374 License Status: FL Residential Contractor

License Date: _____ License Expires: 8/31/2024

PR
6 May 2024

Improvements other than New Home Construction

Please submit this completed form along with a plans detailing all proposed improvements/alterations. The plans should be to scale and show the location of the proposed improvements/alterations in relation to the existing house, all other improvements on the lot, building setbacks and property lines. Details on the plans shall include, as appropriate, the height, color, building styles/materials, plant species, landscape materials, irrigation plans, and any changes in grading/elevation. Photos, drawings, proposals and brochures of the proposed project may also be submitted.

Requests can be e-mailed to mary.jackson@tpam.biz or mailed to: P O Box 12412, Tallahassee, FL 32317.

The Property Owner hereby acknowledges his/her awareness and understanding of the following (initial each line below):

AR

_____ No grading, tree removal, construction, improvement or alteration may begin without ACC approval.

AR

_____ Owners shall abide by City of Tallahassee/Leon County requirements (e.g., setbacks, permits) and those specified in the Bull Run Covenants when making modifications or additions to their property

PROPERTY OWNER SIGNATURE: _____

PRINTED NAME: _____

DATE: _____

Amanda Ross *Amanda Ross* 4/10/24

signing as an authorized agent of NRG Industries
(contractor)

ACC Approval:

Phillip Ross *

6 May 2024

* approved on the basis of the attached pictures & sketch

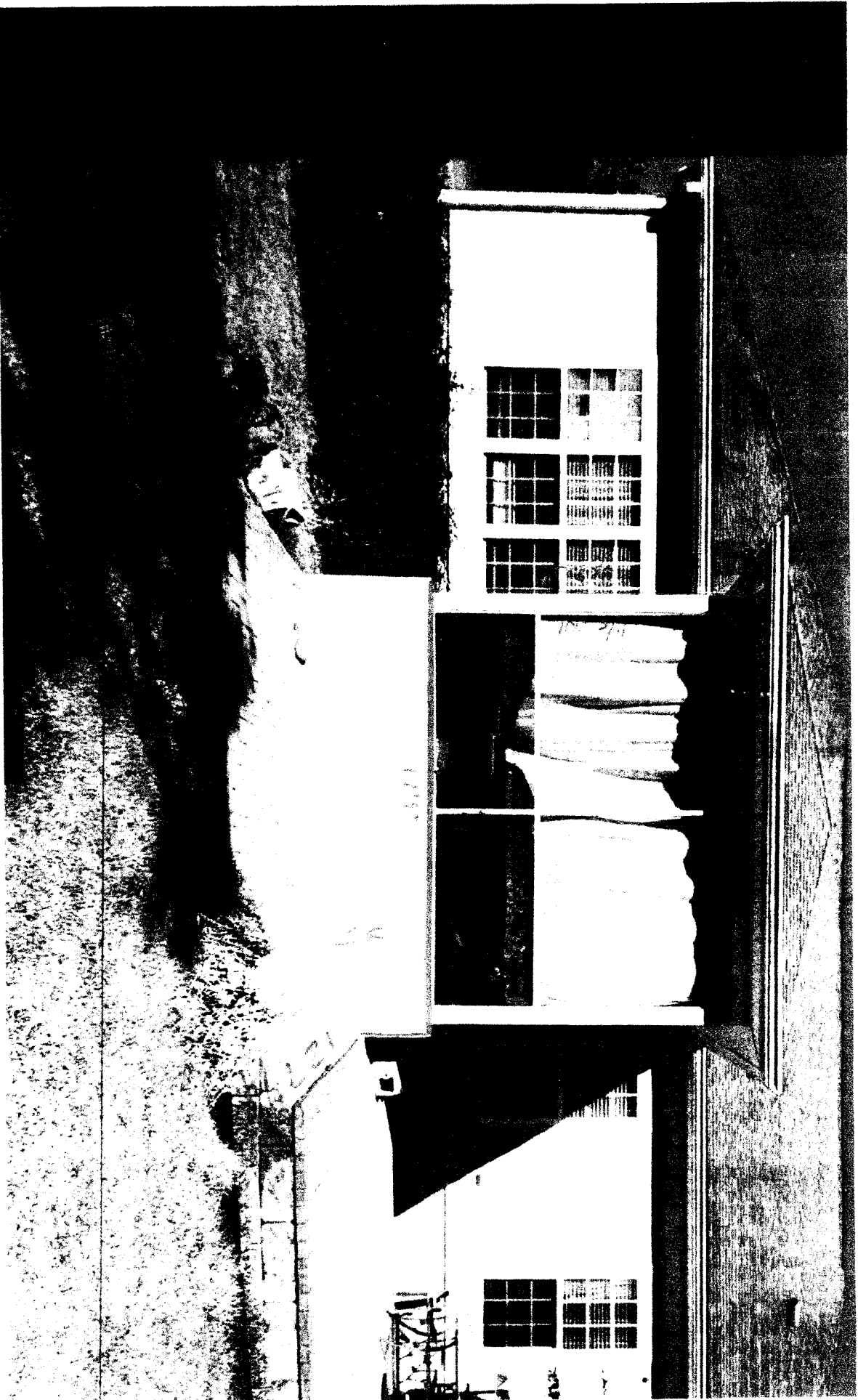

OR
6 May 2024

Summer Hill Lc

5711

5707

↑

40'

10' 10' 10'

30'

12'

new deck

10' x 12'

existing screen porch

* Construct a 20' x 12' glass sunroom

TLOGIS TLOGIS LCPAQ TLOGIS LCPA LBCC

Leon County Property Appraiser

Signature
 May 2024

Legend		
	Township	Building
	Section	Park
	Subdivision	City Limit
	Tax Parcel	Waterbody
	Access Easement	Imagery 1/2015
	River	

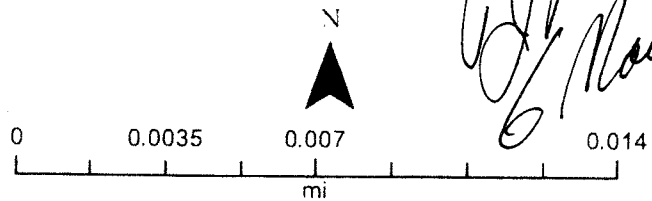

Akin Akinyemi, PhD, RA, CFA, CMS
 Leon County Property Appraiser

315 S. Calhoun St. Third Floor
 Tallahassee, FL 32301

Phone: (850) 606-6200
 Fax: (850) 606-6201

Email: admin@leonpa.org
 Website: leonpa.org

DISCLAIMER: This product has been compiled from the most accurate source data from Leon County, the City of Tallahassee, and the Leon County Property Appraiser's Office. However, this product is for reference purposes only and is not to be construed as a legal document or survey instrument. Any reliance on the information contained herein is at the user's own risk. Leon County, the City of Tallahassee, and the Leon County Property Appraiser's Office assume no responsibility for any use of the information contained herein or any loss resulting therefrom.

Date Printed: Mar 06, 2024